

# TIOMOS 110

110° hinge (door thicknesses up to 24 mm)

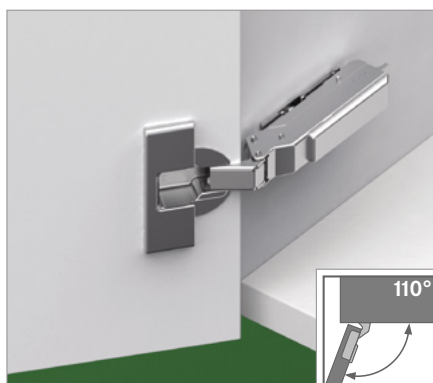

- 110° opening angle
- Optimal reveals for door thicknesses up to 24 mm
- With convenient depth adjustment via worm screw
- 3-dimensional adjustment with corresponding mounting plate
- Surfaces: Nickel or Night (especially for dark cabinet materials and woods)

## Available in four versions:

- With integrated damper (3 adjustable damping levels)
- Without integrated damper
- Without self-closing mechanism (without spring)
- With self-opening mechanism



## ORDER INFORMATION FOR DRILLING PATTERN 45/9.5, NICKEL

Door overlay	Cranking	Damper		Without spring	With self-opening mechanism <sup>3</sup>	Art. No.		
		With	Without			Click-on for screw fitting	Click-on for press fitting	Impresso tool-free
Full overlay <sup>1</sup>		0	■	-	-	F028138519	F028138523	F017139329
			-	■	-	F045138457	F045138461	F034139300
			-	■	■	F046138579	-	F035139357
Overlay <sup>1</sup>		3	■	-	-	F028138520	F028138524	F017139330
			-	■	-	F045138458	F045138462	F034139301
			-	■	■	F046138580	F046138584	F035139358
			-	-	-	F046140360	-	-
Half overlay <sup>2</sup>		9.5	■	-	-	F028138521	F028138525	F017139331
			-	■	-	F045138459	F045138463	F034139302
			-	■	■	F046138581	F046138585	F035139359
			-	-	-	F046140365	-	-
Inset <sup>2</sup>		19	■	-	-	F028138522	F028138526	F017139332
			-	■	-	F045138460	F045138464	F034139303
			-	■	■	F046138582	F046138586	F035139360
			-	-	-	F046140366	-	-

<sup>1</sup> Cup material: steel, nickel-plated/Arm material: steel, nickel-plated

<sup>2</sup> Cup material: steel, nickel-plated/Arm material: zamak, nickel-plated

<sup>3</sup> Additional Tipmatic Plus Pin required

## ORDER INFORMATION FOR DRILLING PATTERN 45/9.5, NIGHT

Door overlay	Cranking	Damper		Without spring		Art. No.		
		With	Without			Click-on for screw fitting		
Overlay <sup>1</sup>		3	■	-	-	F028139129		
			-	■	-	F045140958		
			-	■	■	F046149603		
Half overlay <sup>2</sup>		9.5	■	-	-	F028139130		
			-	■	-	F045140952		
			-	■	■	F046149604		
Inset <sup>2</sup>		19	■	-	-	F028139131		
			-	■	-	F045140955		
			-	■	■	F046149605		

<sup>1</sup> Cup material: steel, Night/Arm material: steel, Night

<sup>2</sup> Cup material: steel, Night/Arm material: zamak, Night

## PAGE REFERENCES

Tiomos mounting plates	86
Accessories	96
Technical information	100

Tipmatic	114
Assembly technology	637
Assembly aids	654

### PLANNING DIMENSIONS

All dimensions in millimetres

Full overlay		K0		Overlay		K3		Half overlay		K9.5		Inset <sup>1</sup>		K19	
		Mounting plate height 2				Mounting plate height 2				Mounting plate height 2				Mounting plate height 2	
														<sup>1</sup> Set mounting plate back by door thickness + 1.5 mm	

### MINIMUM GAP

	Cup distance				
	3	4	5	6	7
24.0	1.0	1.0	1.0	1.2 <sup>2</sup>	2.1 <sup>2</sup>
22.0	1.0	1.0	1.0	1.0	1.5 <sup>2</sup>
21.0	1.0	1.0	1.0	1.0	1.2 <sup>2</sup>
20.0	1.0	1.0	1.0	1.0	1.0
19.0	1.0	1.0	1.0	1.0	1.0
18.0	1.0	1.0	1.0	1.0	1.0
17.0	1.0	1.0	1.0	1.0	1.0
16.0	1.0	1.0	1.0	1.0	1.0

Door thickness

Minimum gap

<sup>2</sup> 1.0 with 85° opening angle

### MINIMUM REVEAL

	Cup distance				
	3	4	5	6	7
24.0	2.4	2.1	2.1	2.1	2.0
22.0	1.6	1.6	1.6	1.5	1.5
21.0	1.4	1.3	1.3	1.3	1.3
20.0	1.1	1.1	1.1	1.1	1.1
19.0	0.9	0.9	0.9	0.9	0.9
18.0	0.7	0.7	0.7	0.7	0.7
17.0	0.6	0.6	0.6	0.6	0.6
16.0	0.6	0.6	0.6	0.6	0.6

Door thickness

Minimum reveal (F)

### 85° OPENING ANGLE

	Cup distance				
	3	4	5	6	7
36.0	11.1	10.3	9.7	9.1	8.5
30.0	5.4	4.8	4.4	4.3	4.2
28.0	3.7	3.6	3.5	3.4	3.3
26.0	2.9	2.8	2.8	2.7	2.6
24.0	2.2	2.1	2.1	2.1	2.0
22.0	1.6	1.6	1.6	1.5	1.5
21.0	1.4	1.3	1.3	1.3	1.3
20.0	1.1	1.1	1.1	1.1	1.1
19.0	0.9	0.9	0.9	0.9	0.9
18.0	0.7	0.7	0.7	0.7	0.7
16.0	0.6	0.6	0.6	0.6	0.6

Door thickness

Minimum reveal (F) <sup>3</sup> at 85°

<sup>3</sup> 85° opening angle reduction clip

### NOTES

The minimum gap is the clearance required between the cabinet face and the closed door so that the door can be opened without hindrance.

Minimum reveal for doors with chamfered edges (R = 1 mm) with factory setting.

A trial fitting is recommended for door thicknesses from 24 mm.

### DRILLING PATTERNS 45/9.5

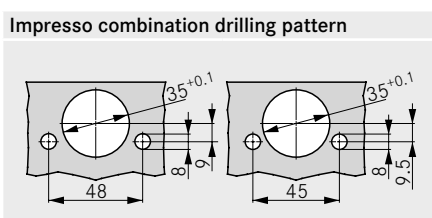
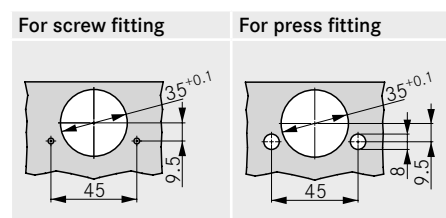

### CUP DIMENSIONS

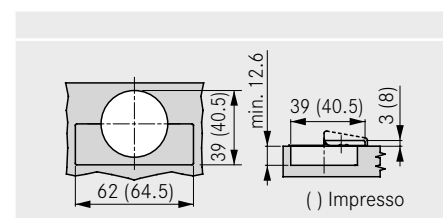

# TIOMOS Click-on

F072135764000 – 02/2011

Bedienungsanleitung / User manual / Mode d'emploi / Istruzioni d'uso / Instrucciones de uso / Monteringsanvisning

**Scharnieranzahl / Number of hinges / Nombre de charnières /**  
**Numero die cerniere / Número de bisagras / Antal gångjärn**

**DEU** Scharnieranzahl pro Tür ist abhängig von Türhöhe, Türgewicht oder Materialqualität. Im Zweifelsfall ist die Scharnieranzahl durch einen Probeanschlag zu ermitteln.

**ENG** Number of hinges per door is depending on height and weight of the door or quality of the material. In cases of uncertainty, the number of hinges should be determined with a trial installation.

**FRA** Le nombre de charnières pour une porte à utiliser est déterminé par la hauteur, le poids de la porte et la qualité du matériau. En cas de doute, le nombre de charnières à utiliser doit être déterminé au moyen d'un essai de montage préalable.

**ITA** Fattori determinanti per numero di cerniere per anta sono l'altezza, il peso dell'anta e la qualità del materiale. Nel dubbio calcolare il numero di cerniere con un sormonto di prova.

**ESP** La altura de la puerta, el peso de la puerta, la calidad del material y las bases son factores decisivos para el número de las bisagras por puerta. En caso de duda recomendamos realizar un montaje de prueba para determinar el número adecuado de bisagras.

**SWE** Antal gångjärn per dörr beror på dörrens höjd, vikt och material. Vi rekommenderar en testmontering.

Scharnieranzahl / Number of hinges /  
 Nombre de charnières / Numero di cerniere /  
 Número de bisagras / Antal gångjärn

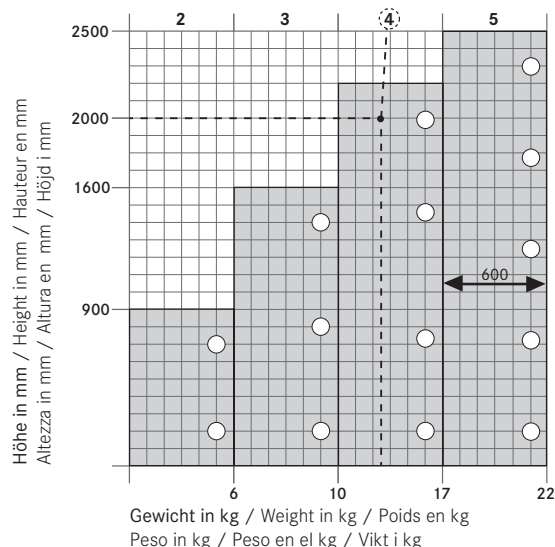

**Dämpferverstellung / Adjustment of damper / Réglage de l'armortisseur /**  
**Regolazione de l'armortizzatore / Ajuste de l' amortiguador / Inställning av dämparkraften**

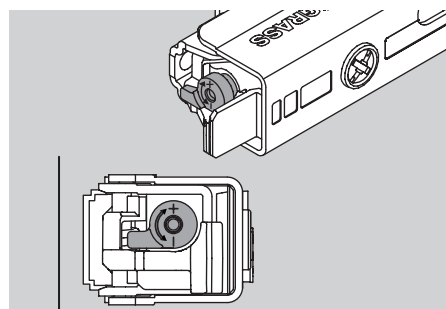

**Leichte Stufe – für leichte und schmale Türen**  
 Low level – for light and small doors  
 Étape faible – pour des portes faciles et étroites  
 Tappa debole – per porte facili e strette  
 Etapa escasa – para puertas fáciles y estrechas  
 Svag inställning – för lätta och smala dörrar

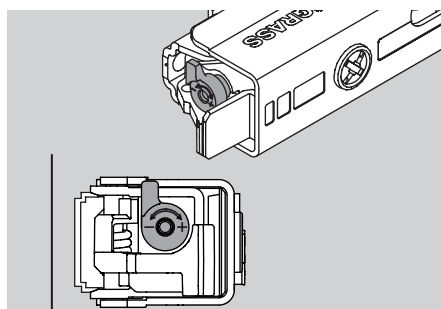

**Mittlere Stufe/Werkseinstellung – für Standardtüren**  
 Middle level/factory setting – for standard doors  
 Étape moyen/réglage d'usine – pour portes standard  
 Tappa medio/regolazione di fabbrica-per ante standard  
 Etapa escasa/sjuste defabrica – para puertas estándar  
 Medel inställning – för standarddörrar

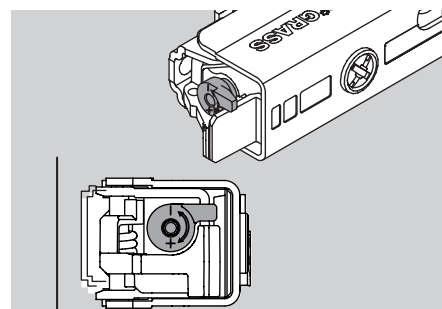

**Schwere Stufe – für große und schwere Türen**  
 High level – for large and heavy doors  
 Étape lourde – pour de portes grandes et lourdes  
 Tappa pesante – per porte grandi e pesanti  
 Etapa pesada – para puertas grandes y pesadas  
 Hård inställning – för stora och tunga dörrar

**3D Verstellung / 3D adjustment / Réglage 3D / Regolazione 3D / Ajuste 3D / 3D Justering**

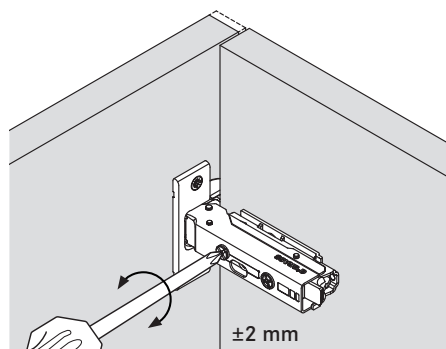

**Seitenverstellung / Side adjustment / Réglage latéral**  
 Regolazione laterale / Ajuste lateral / Sidjustering

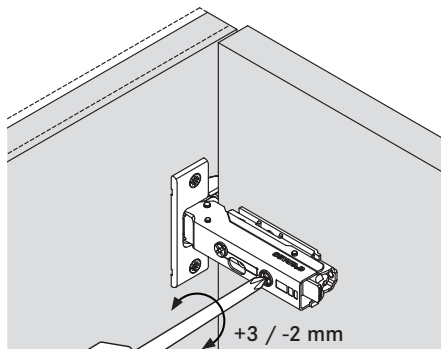

**Tiefenverstellung / Depth adjustment / Réglage en profondeur**  
 Regolazione della profondità / Ajuste de profundidad / Djupjustering

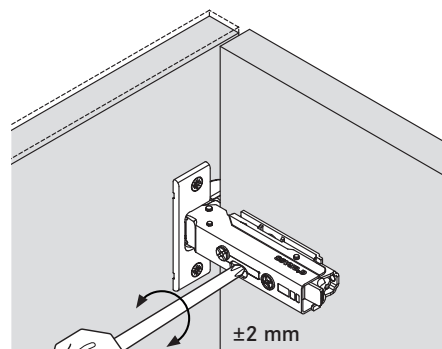

**Höhenverstellung ist abhängig von der Montageplatte /**  
 Height adjustment, depends on the type of mounting plate / Réglage en hauteur dépend de la plaque de montage / Regolazione in altezza dipende dalla piastrina di montaggio / Ajuste de altura depende de la base / Höjdjustering. Beror på vilken monteringsplatta som används