

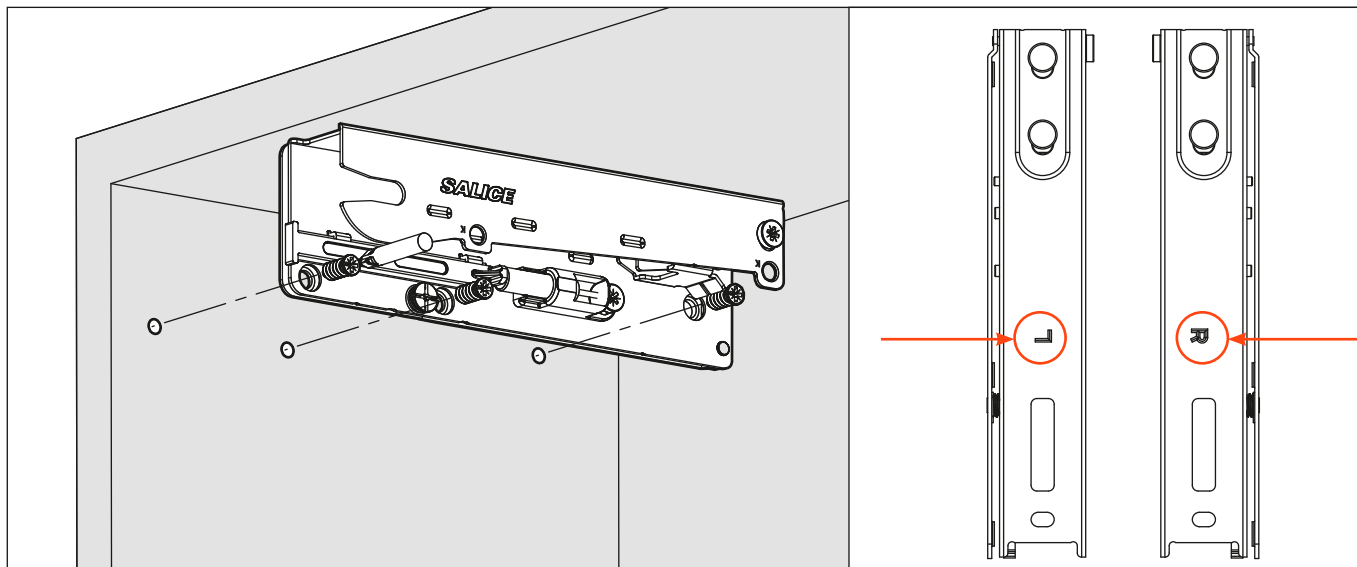

## Fixing the plates to the cabinet sides

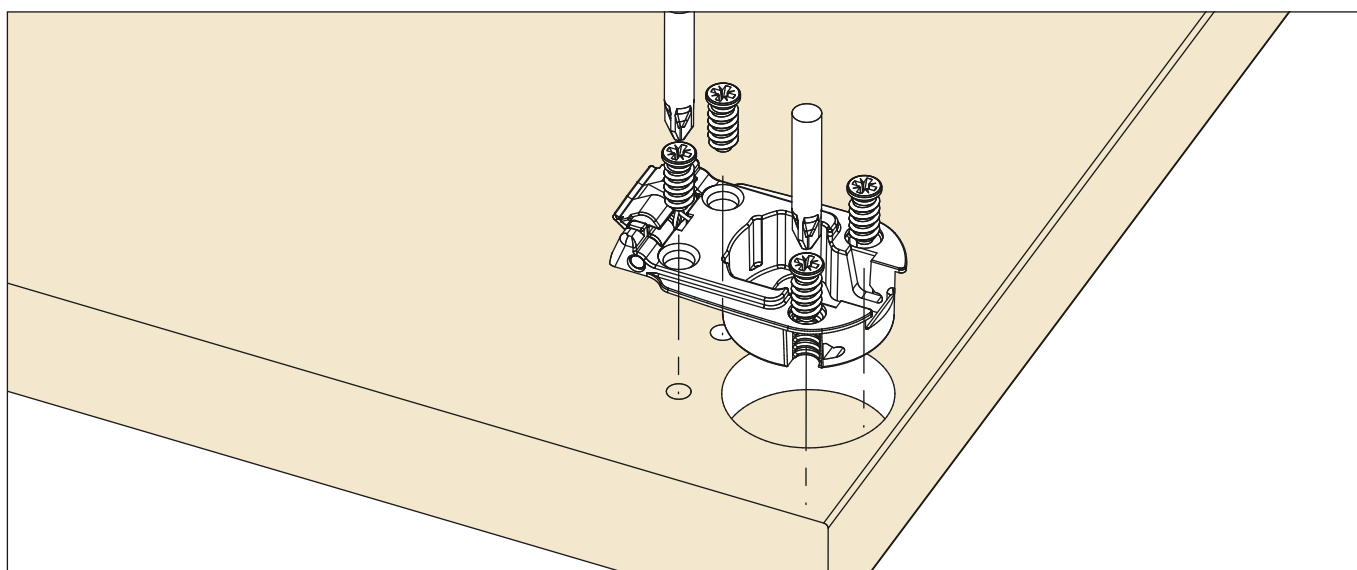

## Fixing the cups to the door



## Deploying the system to the cups

Connecting the system to the cups. This operation is tool free.

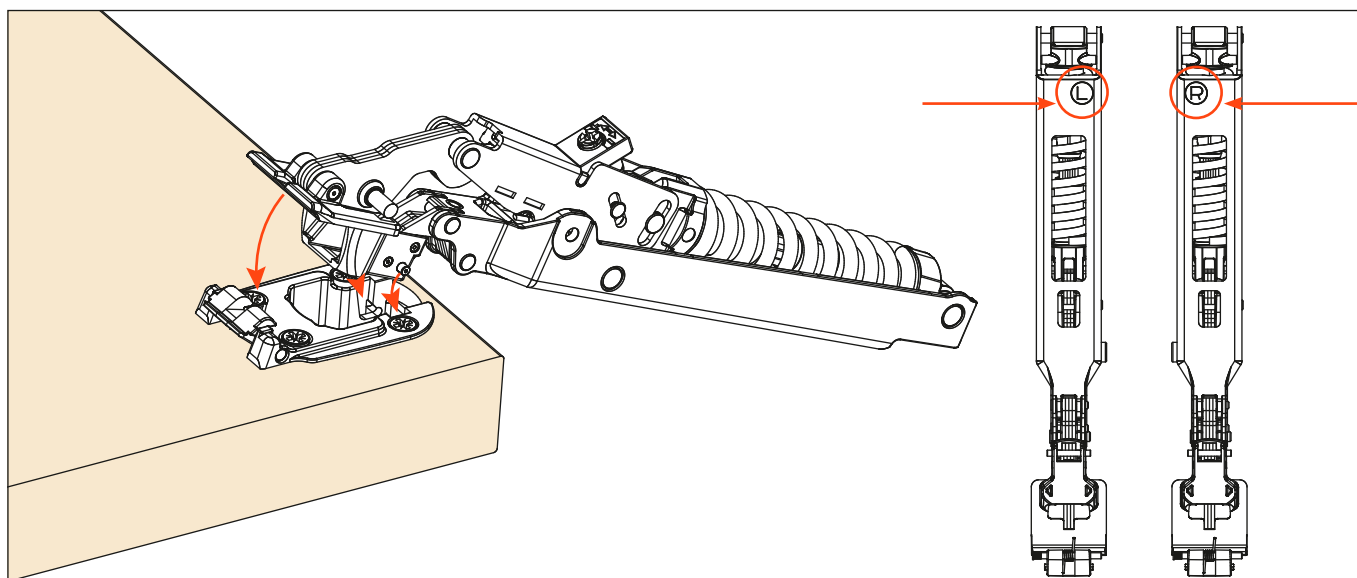

## Installing the system to the plates

Installing the system till the back fixing. This operation is tool free.

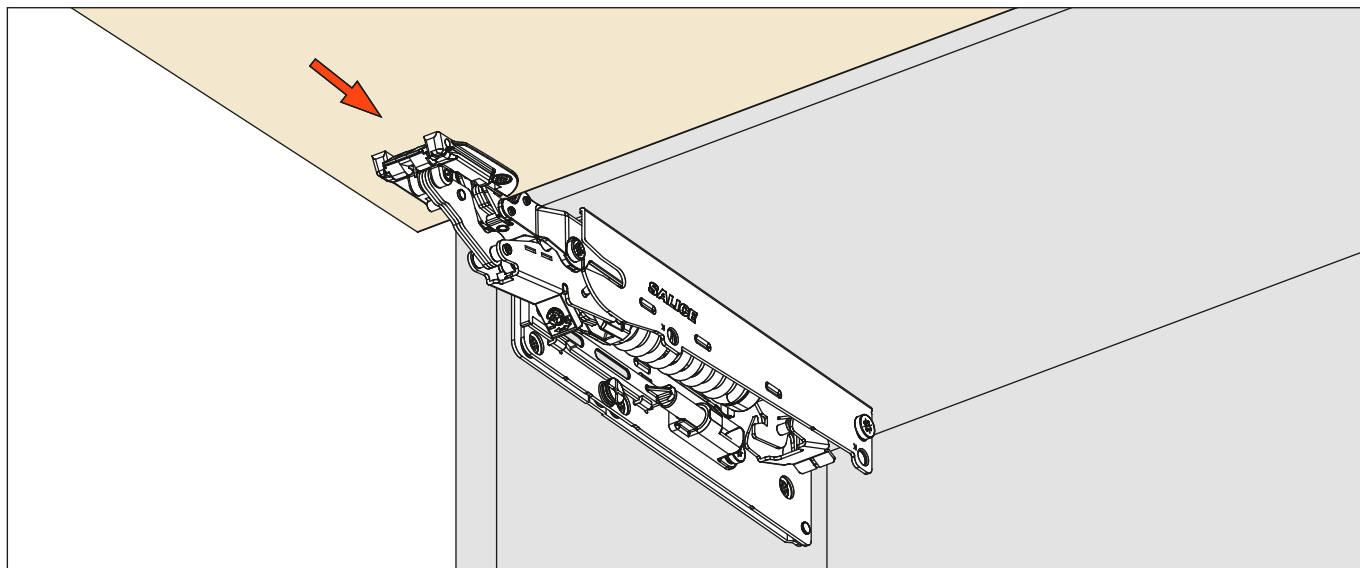

## Installing the covers

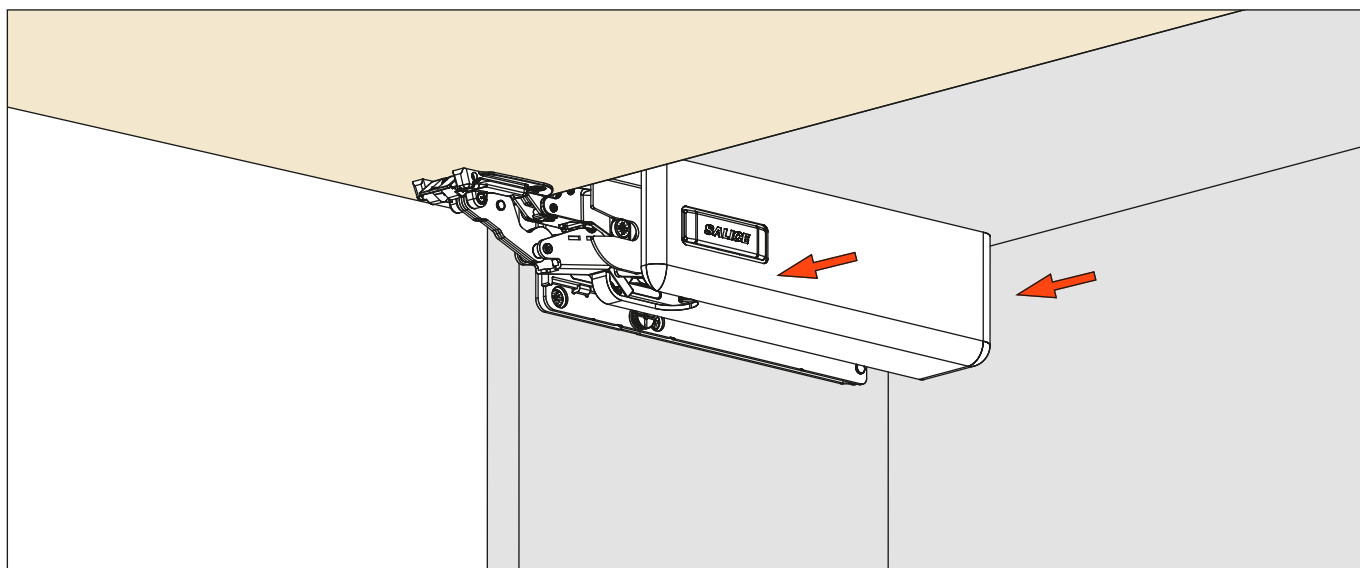

### **WARNING ! Security cable ties**

Remove the cable ties only at the end of the assembly.  
Use the instructions and the QR Code attached to the systems.



## Removal of the covers

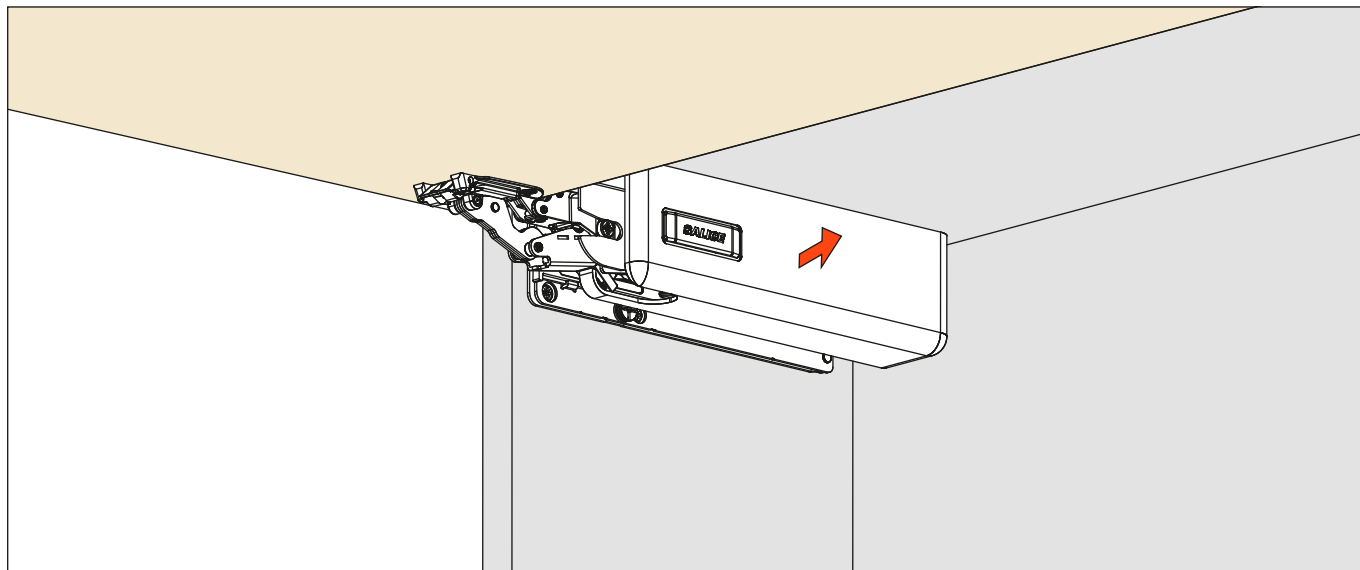

## Disassembly of the system

Press the back lever and pull out the system. This operation is tool free.

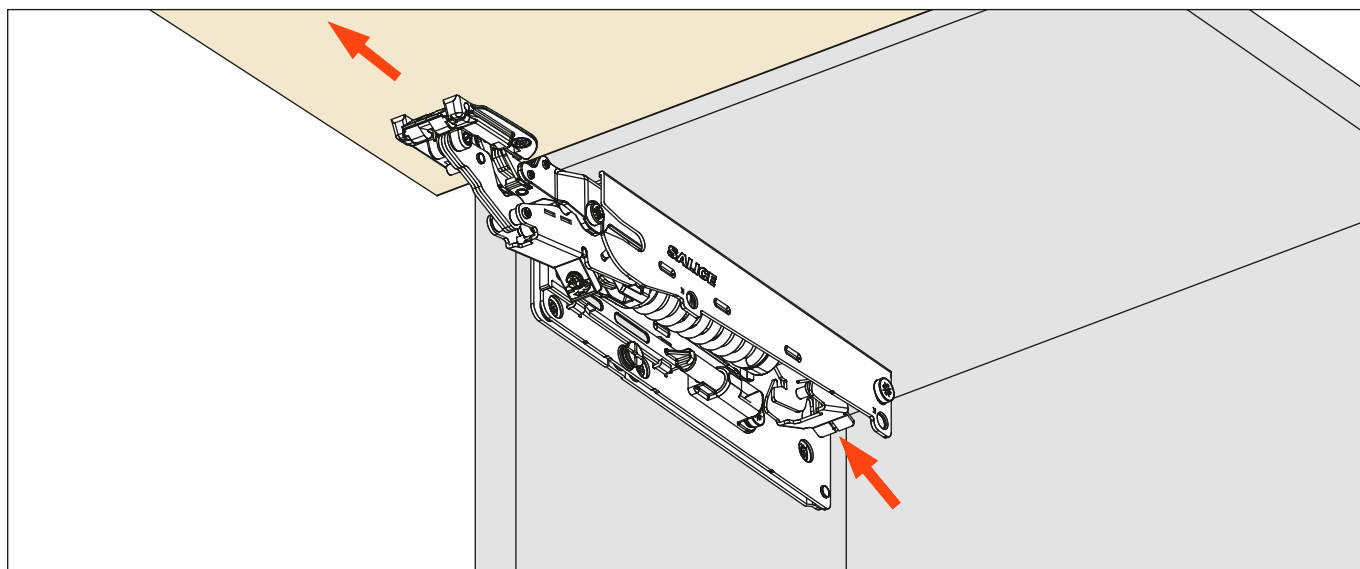

## Unfasten the system from the cups

Disconnecting the system from the cups. This operation is tool free.

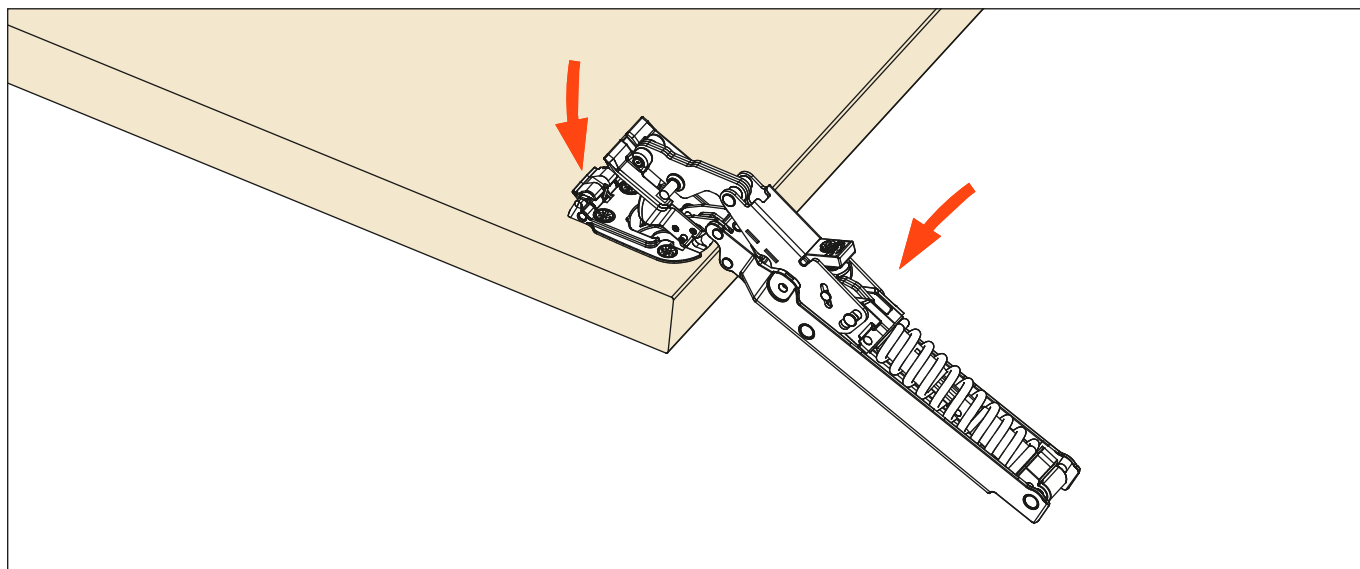

**1 - adjustment of the spring strength**

**2 - adjustment of the decelerating effect**

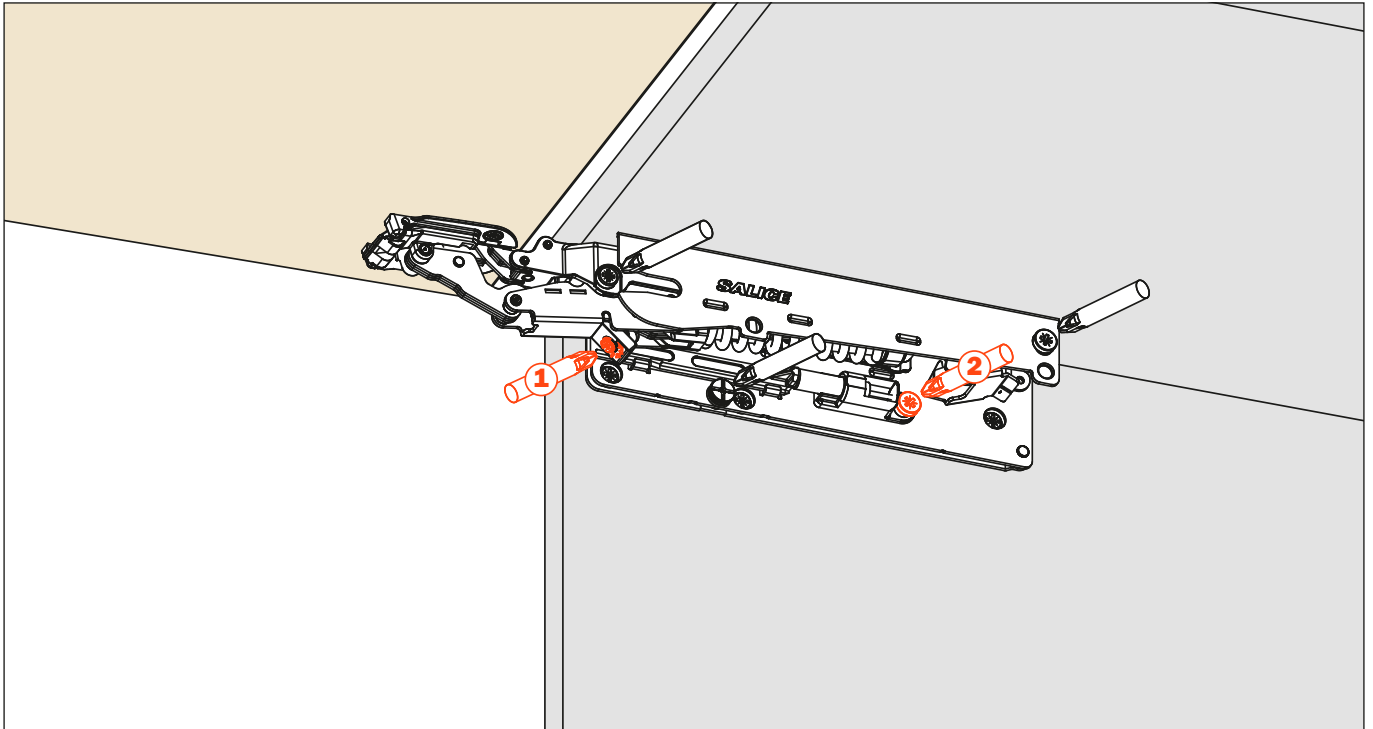

**3 - height adjustment of the door from - 2 to +2**

**4 - sideways adjustment of the door from - 2 to +2**

**5 - depth adjustment of the door from - 1 to +3**

